



FOR LEASE

GLENDALE NORTHWEST PHASE I

18185 N. 83RD AVENUE, GLENDALE AZ 85308

DEMOGRAPHICS

| POPULATION | 1MI | 3MI | 5MI |
|----------------------|----------|----------|----------|
| 2010 Est. Population | 16,385 | 117,688 | 273,810 |
| Growth: 2010-2015 | 15.88% | 13.51% | 12.04% |
| Per Capita Income | \$32,970 | \$32,645 | \$30,638 |
| Average Age | 40.66 | 41.49 | 40.95 |

| HOUSEHOLDS | 1MI | 3MI | 5MI |
|-----------------------|----------|----------|----------|
| 2011 Est. Households | 6,351 | 45,153 | 103,047 |
| Growth: 2010-2015 | 15.14% | 12.13% | 10.73% |
| Est. Median HH Income | \$64,498 | \$69,525 | \$65,170 |

| TRAFFIC COUNTS | 83rd Ave | Bell Rd |
|----------------|----------|---------|
| | 19,881 | 39,039 |

PROJECT HIGHLIGHTS

- Total Building Size: 25,222 SF
- +/- 5.0/1,000 SF Total Parking
- Abundant Covered Parking
- Location: Premier location with freeway access
- Lobby Directory and Suite Entry Signage
- Telecommunications: Century Link Fiber

CONTACT

Jason Hersker, Director of Leasing and Sales
 Cell: 602.370.9605 E-mail: jhersker@thecapitalcos.com

Rachael Cisco, Leasing Associate
 Cell: 602.708.1110 E-mail: rcisco@thecapitalcos.com

Scott Smith, Designated Broker
 Cell: 602.541.3347 E-mail: ssmith@thecapitalcos.com

www.thecapitalcos.com

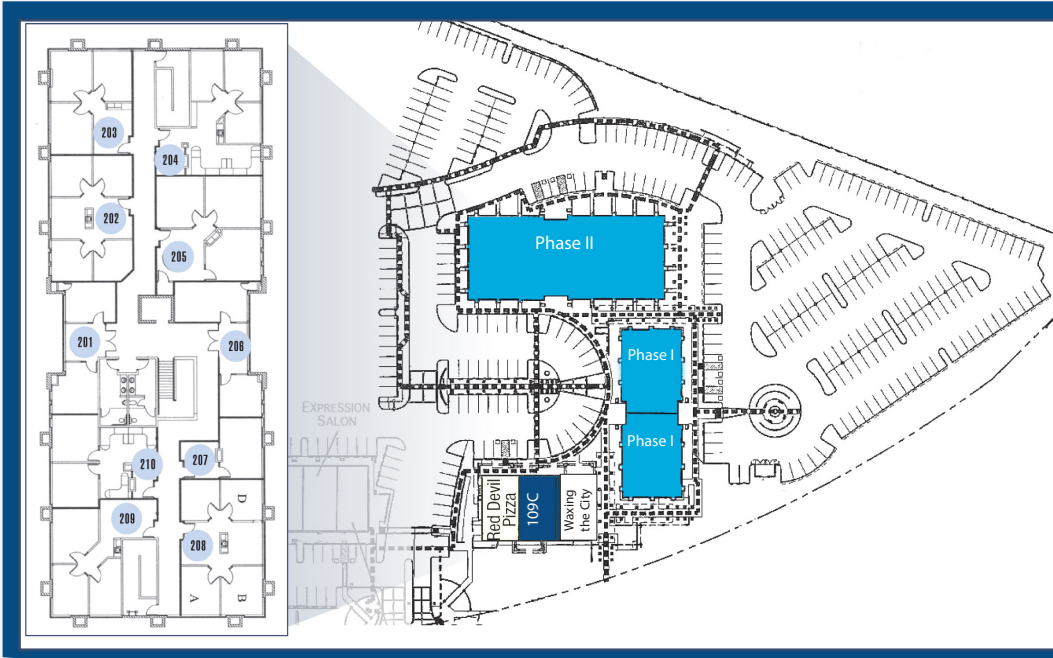

AVAILABLE SUITES

01 Office

First Floor

- 101 4,354 SF Vanguard Health Systems
- 107 4,523 SF Arizona School of Real Estate and Business

Second Floor

- 201 664 SF Plan B Facility Services
- 202 1,200 SF Financial Services
- 203 906 SF Farmers Insurance
- 204 1,106 SF Law Office
- 205 1,185 SF Country Insurance
- 206 757 SF AVAILABLE
- 207 482 SF Accent Care, Inc.
- 208A 282 SF AVAILABLE
- 208D 306 SF AVAILABLE
- 209 959 SF Law Office
- 210 902 SF Bloom Tree Realty

02 Retail

- 111C Waxing the City
- 112C AVAILABLE 1,625 SF
- 113C Red Devil Pizza

CONTACT

Jason Hersker, Director of Leasing and Sales
 Cell: 602.370.9605
 jhersker@thecapitalcos.com

Rachael Cisco, Leasing Associate
 Cell: 602.708.1110
 rcisco@thecapitalcos.com

Scott Smith, Designated Broker
 Cell: 602.541.3347
 ssmith@thecapitalcos.com

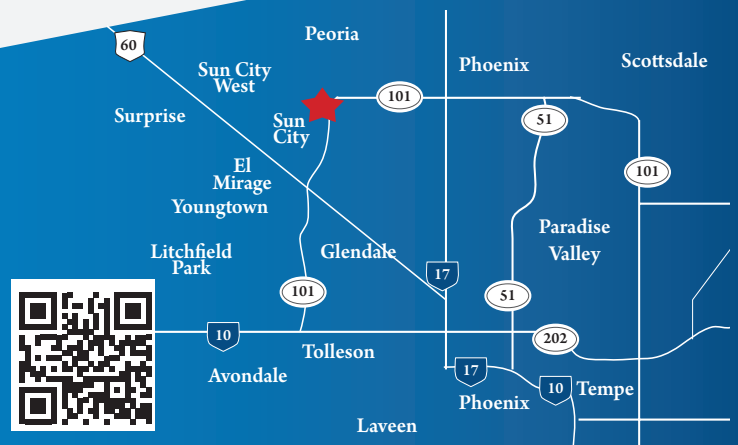

No warranty or representation, expressed or implied, is made as to the accuracy of the information contained herein. Terms of sale or lease and availability are subject to change or withdrawal without notice.